

Service doors

■ Service door | ■ Service door Polypropylene | ■ Service door inox



Service doors



Leaf: thickness of 40 mm. Single or double leaf door.

- Suitable for working areas, corridors, offices and lavatories, etc.
- Finishes: white painted, PVC, stainless steel, polyester or Formica with anodised aluminium surrounding
- PUR or PIR insulation with a density of 40-45 kg/m³

Frame made of silver polished anodised aluminium prepared for any panel thickness or wall with wall anchors.

Hardware made of stainless steel.

Accessories: colors of our standard color card or RAL card, different vision panels, frames for meat rail, 4-sided frames, door closer, panic bar, kickplates, electrical opening, interlocking system, bottom gasket, ventilation grill, toilet lock, master key, etc.



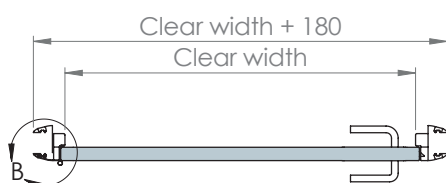
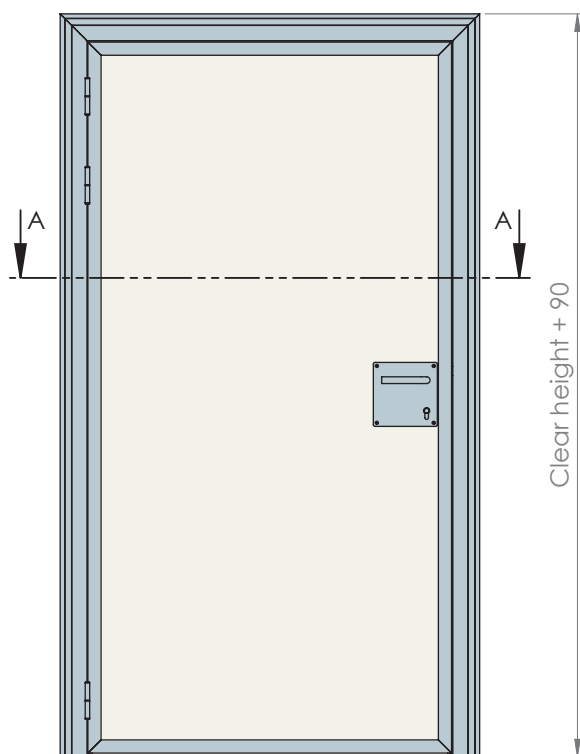

ALUMINIUM FRAME

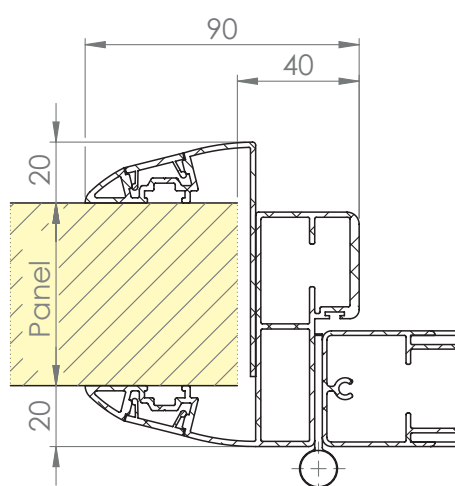

PANEL CUT-OUT	
Width	Height
40 + clear + 40	40 + clear

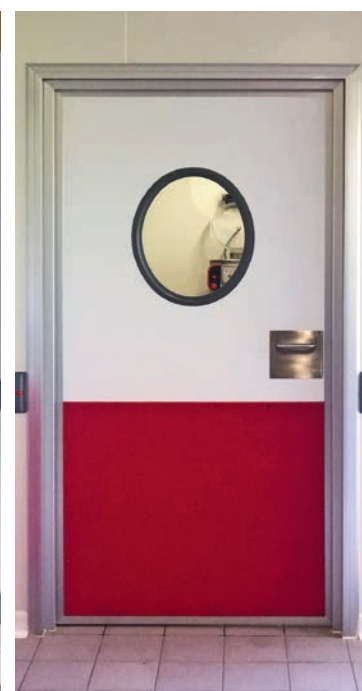

Service doors polypropylene

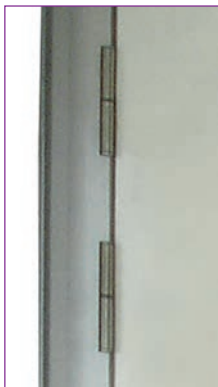

Leaf: thickness of the leaf 40 mm.

- Leaf made of 5 mm polypropylene on each face of the door, with a 30 mm PU-injection
- PUR or PIR insulation with a density of 40-45 kg/m³
- Very sturdy door with high impact resistance. Suitable for working areas, corridors, transit areas, also for aggressive ambience.

Frame made of silver polished anodised aluminium prepared for any panel thickness or wall with wall anchors.

Hardware made of stainless steel.

Accessories: colors of our standard color card or RAL card, different vision panels, frames for meat rail, 4-sided frames, door closer, panic bar, kickplates, electrical opening, interlocking system, bottom gasket, ventilation grill, toilet lock, master key, etc.

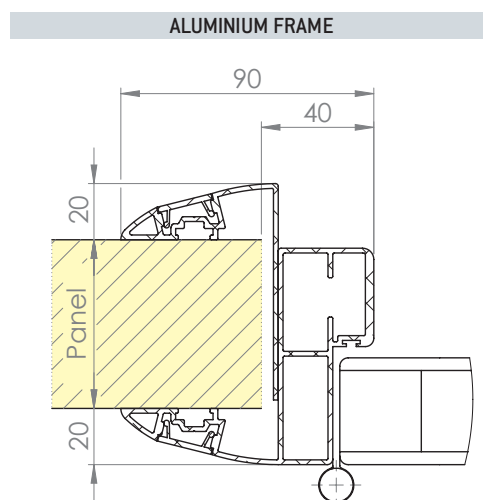
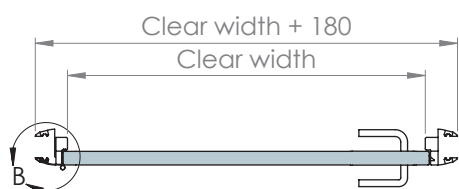
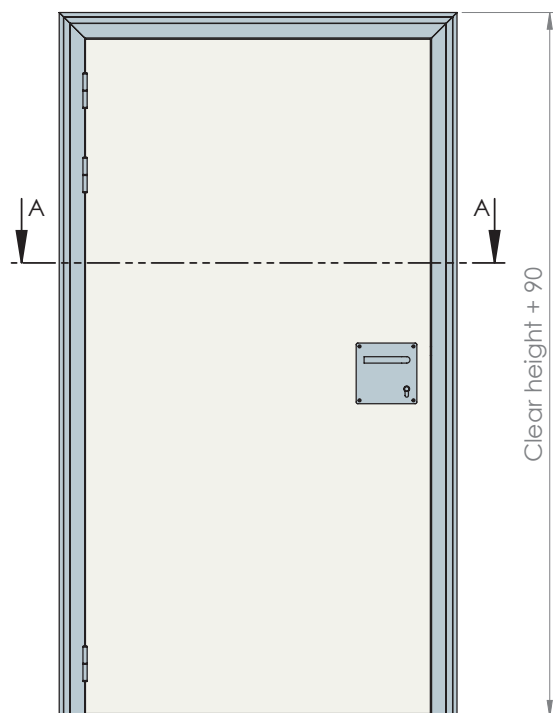

PANEL CUT-OUT	
Width	Height
40 + clear + 40	40 + clear



Version
INOX



Service doors inox



Leaf: thickness of 40 mm. Single or double leaf door.

- Suitable for working areas, corridors, offices and lavatories, etc.
- Finishes: white painted, PVC, stainless steel, polyester or Formica with anodised aluminium surrounding
- PUR or PIR insulation with a density of 40-45 kg/m³

Stainless steel frame prepared for any panel thickness or wall with wall anchors.

Hardware made of stainless steel.

Accessories: different vision panels, frames for meat rail, 4-sided frames, door closer, panic bar, kickplates, electrical opening, interlocking system, bottom gasket, ventilation grill, toilet lock, master key, etc.

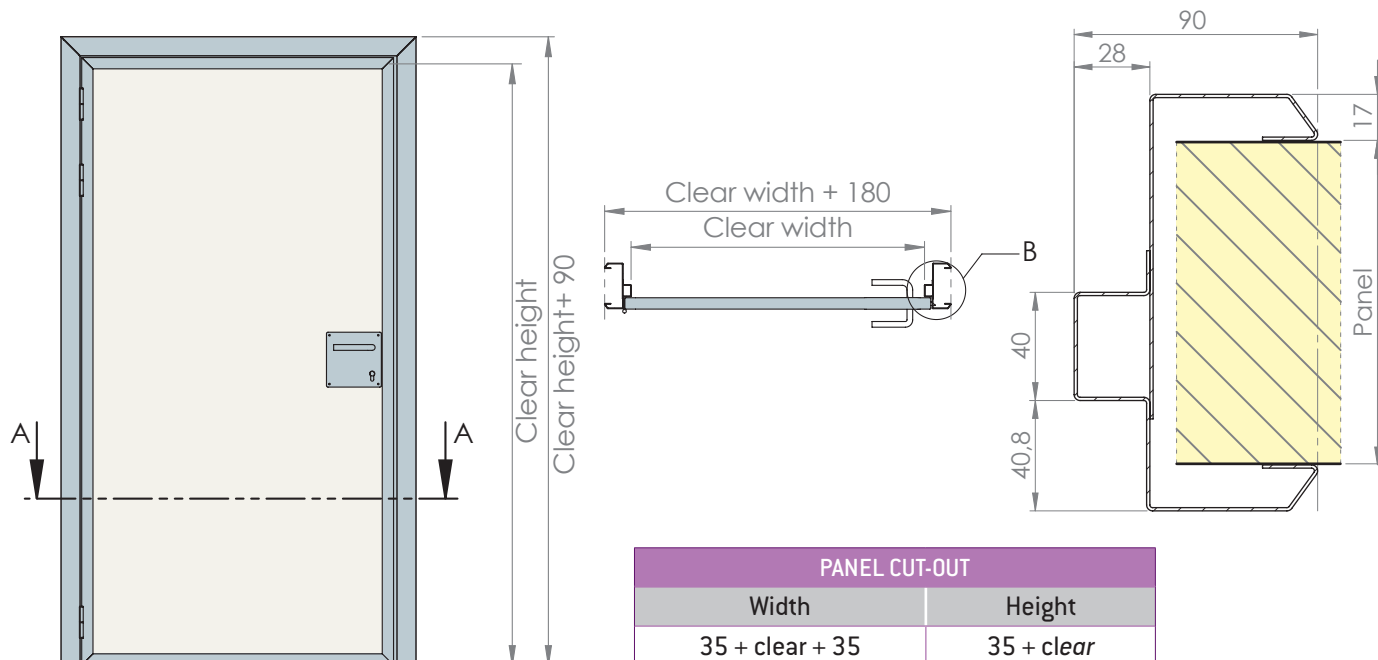



Accessories



Certificates

LGAI Technological Center, S.A.
Campus UAB - Ronda de la Font del Carme s/n
E - 08193 Bellaterra (Barcelona)
T +34 93 567 20 00
F +34 93 567 20 01
www.applus.com



Organismo Notificado Nº 0370

SIMPLIFIED TYPE PRODUCT REPORT

Nr. 17/14501-1047 EN

Bellaterra:

June 6th 2017

Page 1/1

Applicant's reference:

COMERCIAL INDUSTRIAL REPRO, S.L.
Avenida del Mar s/n
46410 SUECA
Valencia

Date of test performance:

May 10th 2017



MATERIAL RECEIVED

A single side-hung door, with total dimensions (frame included) 1080 x 2180 mm (width x height), with a lacquered steel sheets of thickness 0,6 mm and Polyurethane infill, and commercial reference PERSONNEL DOOR.

TEST REQUESTED

The window has been subjected to the following tests of initial type specified in the table, to evaluate its conformity with the requirements defined in the standard UNE-EN 14351-1: 2006 + A1: 2011, "Windows and doors. Part 1: Windows and external pedestrian doorsets without resistance to fire and/or smoke leakage characteristics" harmonized in Regulation (EU) nº 305/2011 'Construction products'.

SUMMARY OF RESULTS

(Complete results can be found in the original test report(s) nº 17/14501-1047)

Test Requested	Requirements UNE-EN 14351-1:2006+A1:2011	Test results
Air Permeability	4.14	CLASE 2
Watertightness	4.5	CLASE 3A
Resistance to wind load	4.2	CLASE C3



Alejandro Gutiérrez Richarte
Technical Manager of windows
LGAI Technological Center, S.A.

Applus+ guarantees that this work has been performed in compliance with the requirements of our Quality and Sustainability System and in conformity to contract provisions and legal regulations. Within the framework of our improvement programme, we would appreciate any comments you would like to make by addressing the person signing this document or the Applus+ Quality Director in the following email: satisfaccion.cliente@applus.com
The results above are only valid in regards to the sample, product or material submitted to the laboratory and subjected to testing under the conditions specified in the standards or procedures mentioned in this document. Reports electronically signed on digital media are considered as an original document, as well as electronic copies of the same. Your print on paper has no legal validity.

The door has been subjected to the following test to evaluate its conformity with the requirements defined in the standard EN 14351-1: 2006 + A1: 2011, "Windows and doors. Part 1: Windows and external pedestrian doorsets without resistance to fire and/or smoke leakage characteristics" harmonized in Regulation (EU) nº 305/2011 'Construction products'.

- Air Permeability: Clase 2
- Watertightness: Clase 3A
- Resistance to wind load: Clase C3

Puertas frigoríficas Insulated doors Portes frigorifiques
Kühlraumtüren Soğuk oda kapıları أبواب معزولة

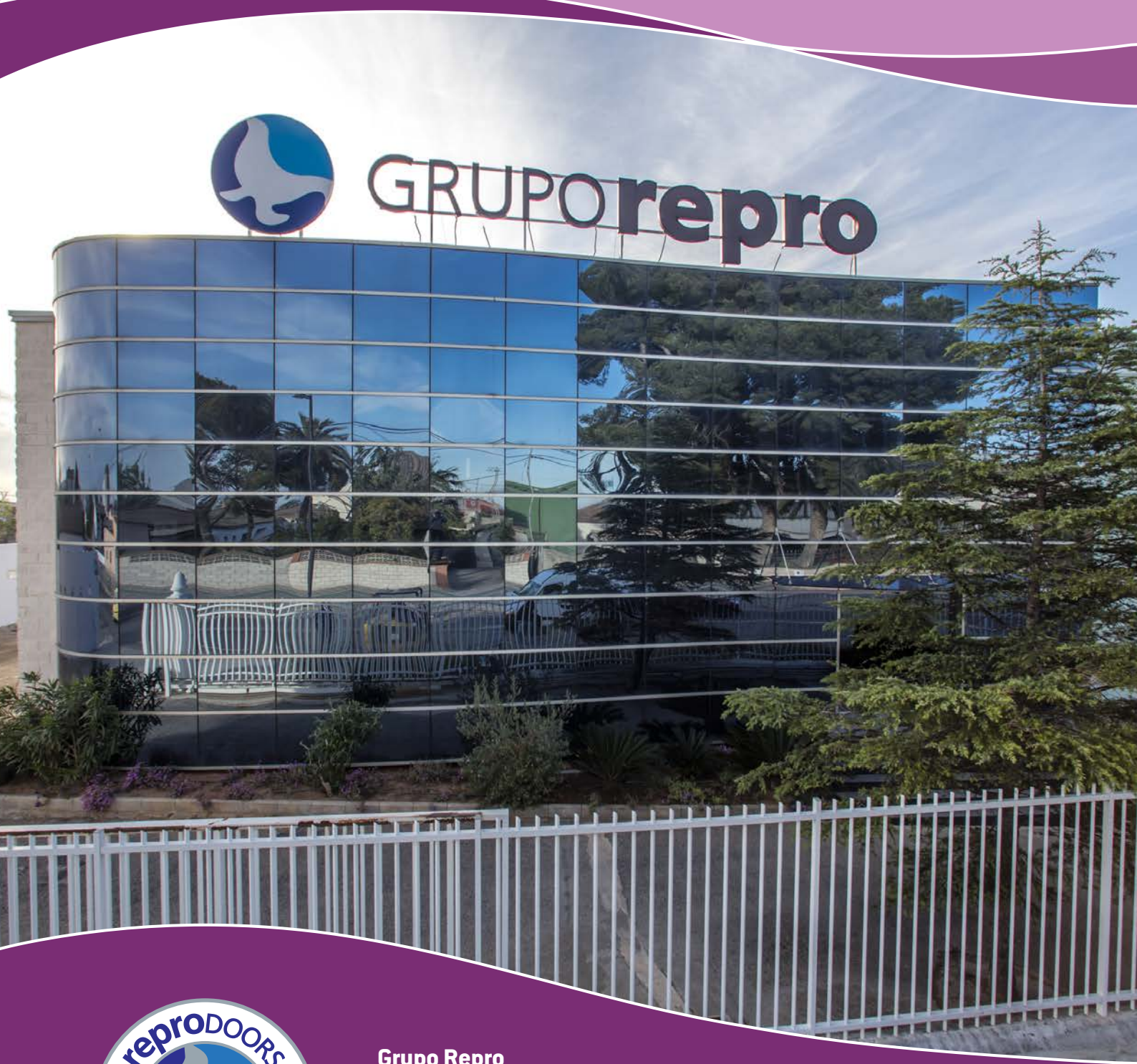

Grupo Repro

Avenida del Mar, s/n - Apartado de Correos 29

46410 SUECA (Valencia) Spain

Tel.: +34 96 171 80 05 - Fax: +34 96 170 09 00

www.repro.es - repro@repro.es